

高山市桐生町五丁目地内

S=1/250

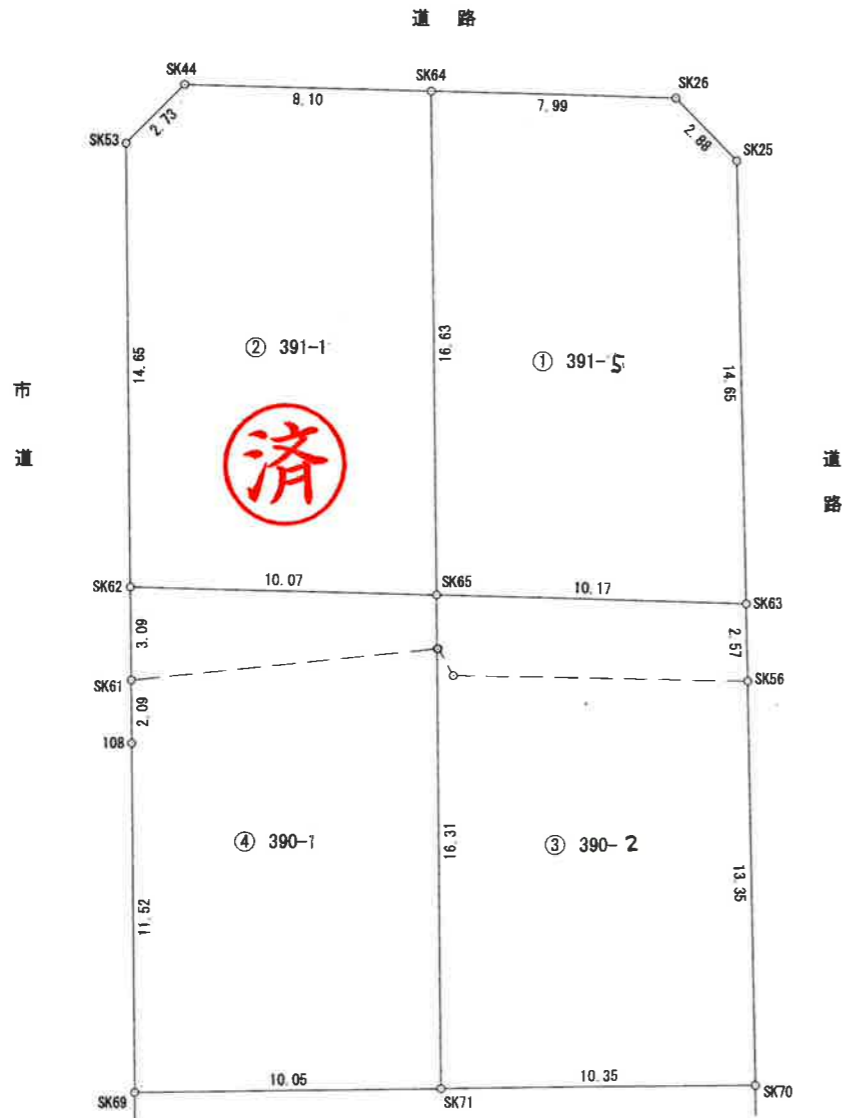
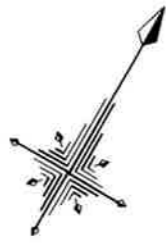

座標求積表

地番 ① 391-5				
NO	Xn	Yn	Yn+1-Yn-1	Xn · (Yn+1-Yn-1)
SK64	17733.668	7798.282	-1.482	-26281.295976
SK26	17737.486	7805.303	9.802	173862.837772
SK25	17736.732	7808.084	10.418	184781.273976
SK63	17724.228	7815.721	-1.299	-23023.772172
SK65	17719.368	7806.785	-17.439	-309008.058552
合計				330.985048
合計面積				165.4925240
地積				165.49 m ²

(50.06坪)

地番 ② 391-1B				
NO	Xn	Yn	Yn+1-Yn-1	Xn · (Yn+1-Yn-1)
SK64	17733.668	7798.282	15.619	276982.160492
SK65	17719.368	7806.785	-0.346	-6130.901328
SK62	17714.555	7797.936	-16.341	-289473.543255
SK53	17727.155	7790.447	-6.770	-120012.839350
SK44	17729.797	7791.167	7.838	138966.148886
合計				331.025445
合計面積				165.5127225
地積				165.51 m ²

(50.06坪)

地番 ③ 390-2				
NO	Xn	Yn	Yn+1-Yn-1	Xn · (Yn+1-Yn-1)
SK65	17719.368	7806.785	0.596	10560.743328
SK63	17724.228	7815.721	10.277	182151.891156
SK56	17722.034	7817.062	8.300	147092.882200
SK70	17710.641	7824.021	-1.937	-34305.511617
SK71	17705.341	7815.125	-17.236	-305169.257476
合計				330.747591
合計面積				165.3737955
地積				165.37 m ²

(50.02坪)

地番 ④ 390-1				
NO	Xn	Yn	Yn+1-Yn-1	Xn · (Yn+1-Yn-1)
SK62	17714.555	7797.936	7.268	128749.385740
SK65	17719.368	7806.785	17.189	304578.216552
SK71	17705.341	7815.125	-0.299	-5293.896959
SK69	17700.195	7806.486	-14.538	-257325.434910
108	17710.097	7800.587	-6.969	-123421.665993
SK61	17711.896	7799.517	-2.651	-46954.236296
合計				332.368134
合計面積				166.1840670
地積				166.18 m ²

(50.26坪)

合計 662.5631090